

# WC-385 style

Workcentre 385, WC-390... Docuprint P8e, P8ex, also Lexmark Optra E310

## TONER / COPY CARTRIDGES

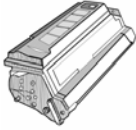

**(Reconditioned):**

WC385CTGR \$65.-

## CARTRIDGE RECONDITIONING KIT

(Drum, Recovery Blade, Toner Refill, & Fuse)

WC385RK (Kit): \$35.-

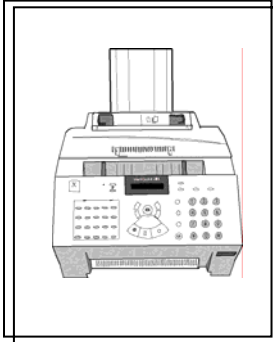

## FEED ROLL ASSY.

WC385FR \$40.-

## RETARD PAD ASSY.

(Primary)

WC385RP \$10.-

## SUB RETARD KIT

(small right & left pads)

WC385SRK \$12.-

## UPPER FUSER ASSEMBLY

(Includes: Upper Roll, Fuser Lamp, Thermistor, Thermal Fuse, Fingers, bushings, etc.)

WC385UFA (OEM): \$85.-

## UPPER FUSER HEAT ROLLER

(Generic)

WC385UFR \$35.-

## LOWER FUSER PRESSURE ROLLER

WC385LFR (Generic): \$40.-

## FUSER DRIVE GEAR

WC385FDG (OEM): \$15.-

## THERMAL FUSE

WC385THF (OEM): \$25.-

## THERMISTOR

WC385THR (OEM): \$35.-

## FUSER LAMP

(Generic)

WC385FL \$35.-

## DOCUMENT FEED PARTS

### DOCUMENT FEED ROLL

WC385DFR \$45.-

### DOCUMENT RETARD PAD KIT

WC385DRPK \$12.-

### DOCUMENT CATCH TRAY

WC385DCT \$15.-

- Transfer Roll: \$25.-
- Contact Image Sensor: \$45.-
- WC-385 Sub HVPS: \$30.-
- Laser Unit: \$45.-
- Main Drive Assy.: \$45.-

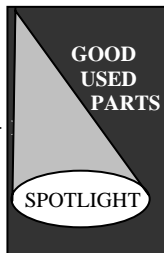

- Control Console: \$65.-
- Scan PWB: \$25.-
- Pretransfer Lamp: \$25.-
- Sensor PWB: \$20.-
- Doc Feed Tray: \$25.-

# WC-385 style

Workcentre 385, WC-390... Docuprint P8e, P8ex, also Lexmark Optra E310

## **WC-385 style Copy / Print Cartridges:**

Workcentre / WC-385, WC-390

Docuprint P8e, P8ex

Also: Lexmark Optra E310

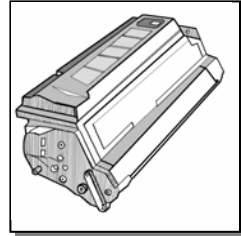

### **Available Parts:** (See p.109)

Drum, Toner, Recovery Blade, Fuse

### **Information:**

*Full Instructional:* Available on our Website

Stated Yield: 5,000 copies (Based on 5% coverage)

OEM "Reorder #'s" WC385 (US): 113R296, WC390: 113R462

### **Basic Procedure:** (full instructional on our Website)

- Disassemble... be careful not to get fingerprints on the PCR Roll.
- Clean up the cartridge parts thoroughly with a vacuum, brush and toner cloths.
- Replace the drum, the Recovery Blade and Fuse.
- Fill the toner compartment (flip the top cover over and fill it up, then flip the other half of the cartridge over onto it to reassemble)
- Reassemble the cartridge.

Resets automatically once the machine sees toner in the cartridge again (uses a photo sensor system which looks through the middle of the cartridge top to bottom.

## **TECHNICAL INFORMATION...**

### **ERROR MESSAGES:**

**OVERHEAT:** Fuser has overheated... once given time to cool down, the machine will reset automatically if the problem is no longer present.

**PAPER JAM 0 :** Paper jam in the paper feeding area.

**PAPER JAM 1:** Paper jam in the fusing area

**PAPER JAM 2:** Paper jam remains in unit after front door is opened & closed.